

You and your family and friends are cordially invited to the

2018 Plover Summer Picnic of the Green Bay & Western Historical Society

Heritage Park, GBW Milepost 81.4, Plover, Wisconsin

11 a.m. to 7 p.m. Saturday, June 2, 2018 ~ \$15 per person

View the beautifully restored GBW 617 caboose and the Soo Line Bancroft depot!

Schedule of Events

11 a.m. to 5 p.m. Social: Meet and Greet with fellow GBWHS members, along with an open house of the GBW 617 caboose and Bancroft depot

12:30 to 1:30 p.m. Lunch: Grilled Hamburgers, Brats and Hot Dogs, Sides of Pasta Salad and Potato Salad along with Soda, Beer & Water will be served. (Additional dishes welcome!)

5 to 7 p.m. Open slide show. A Carousel projector will be provided. Slides will be limited to one 80 slide carousel for the first round; after everybody has had an opportunity to show slides, additional slides may be shown.

Employees and retirees of the GBW and its connecting railroads, and their spouses, attend and eat for FREE as a Thank You for your many years of safely working and for continuing to share your memories of the GBW with the organization and others.

For up to date information, visit www.GBWHS.com and click on "Meetings."

(see map on other side or next page)

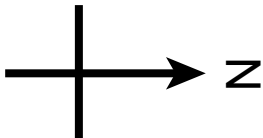

Not to scale

the only railroad that matters!

Business U.S. 51

Washington Ave.

Heritage Park
Plover, Wisconsin

Interstate 39
& U.S. 51

Wisconsin 54

County B

Exit 153

Wisconsin 54
& Business U.S. 51

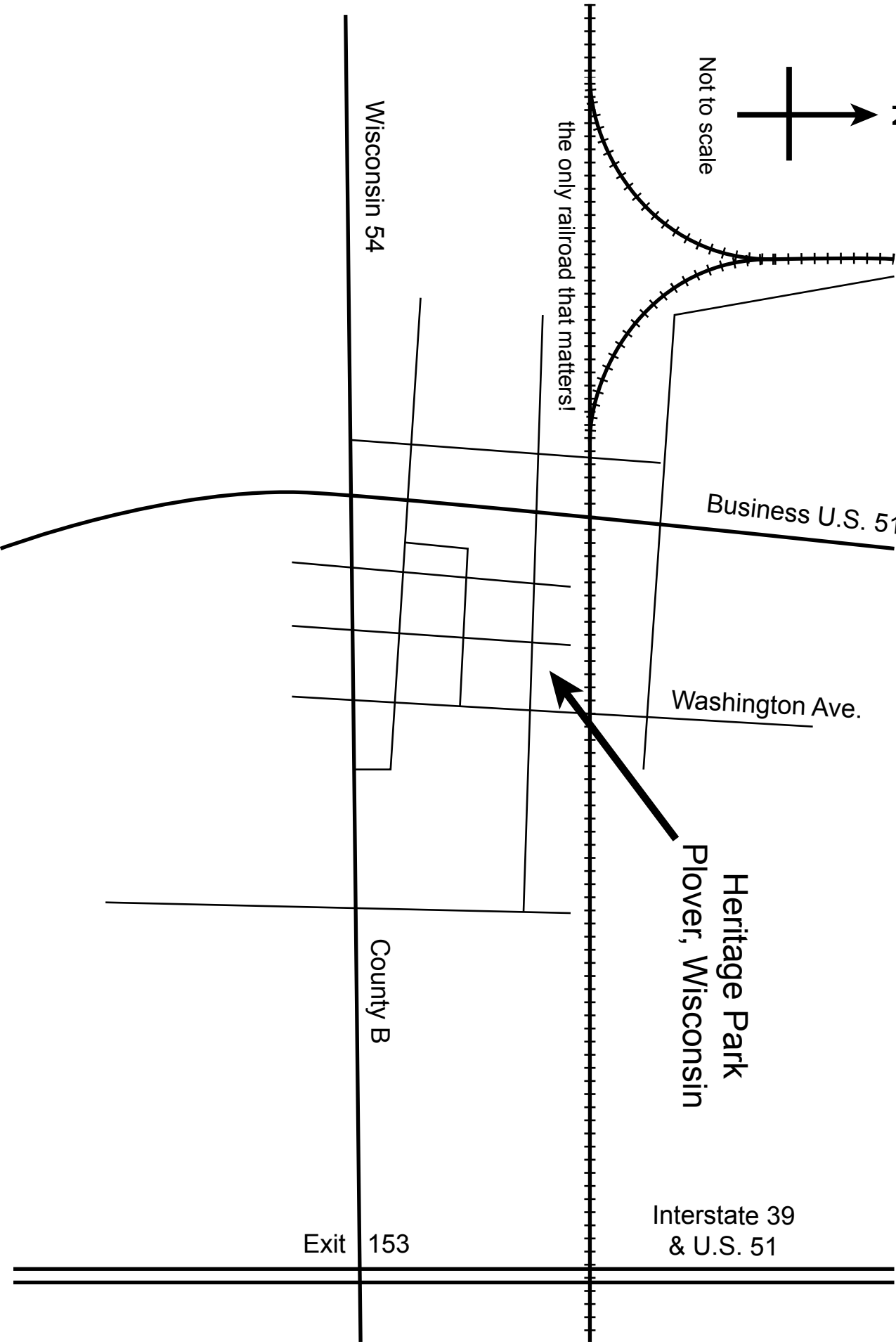

GBWHS 2018 Plover Summer Picnic

Number of railroad employees and spouses: _____ attending and eating free.

Number of other persons: _____ at \$15.00 per person. Total: \$_____

Please include check or money order payable to **GBWHS**.

Please print legibly. Your information will not be used outside the GBWHS.

Name: _____

Address: _____

City, State, Zip: _____

E-mail: _____

Phone: _____

Please send this form and check or money order to:

Green Bay & Western Historical Society
P.O. Box 940
Plover, WI 54467

director5@gbwhs.com